



1 PERSPECTIVE - KITTREDGE ST AND HAROLD WAY CORNER  
A3-203 NOT TO SCALE



2 PERSPECTIVE - KITTREDGE ST RETAIL SPACE  
A3-203 NOT TO SCALE



3 PERSPECTIVE - PERSPECTIVE - KITTREDGE ST PLAZA AND RETAIL  
A3-203 NOT TO SCALE



4 PERSPECTIVE - PERSPECTIVE - KITTREDGE ST PLAZA AND RETAIL  
A3-203 NOT TO SCALE

PROJECT #: 121246  
DRAWN BY: TF, RK  
CHECKED BY: MM

**NILES BOLTON ASSOCIATES**

3060 Peachtree Rd. N.W.  
Suite 600  
Atlanta, GA 30305  
T 404 365 7600  
www.nilesbolton.com

APPLICANT:  
BILL SCHRADER  
T 925 638 8782

No.	Description	Date
2	PRELIM APP 58330	7/21/21
3	SD SET	9/16/21
4	USE PERMIT	10/25/21
5	USE PERMIT RESUBMIT.	12/10/21
6	SAP	12/22/21
8	USE PERMIT RESUBMIT.	3/17/22
9	SAP RESUBMIT.	3/23/22
11	USE PERMIT RESUBMIT.	3/28/22
12	APRIL DRC MEETING	4/11/22
13	JUNE LWRKS. MEETING	5/10/22
14	STAFF REVIEW	07/01/22
15	STAFF REVIEW #2	07/13/22

This drawing, as an instrument of service, is and shall remain the property of the Architect and shall not be reproduced, published or used in any way without the permission of the Architect.

**BERKELEY PLAZA**  
2065 KITTREDGE ST  
BERKELEY, CA 94704

CA VENTURES

SHEET TITLE:  
**PERSPECTIVES**

SHEET NUMBER:  
**A3-203**



1 PERSPECTIVE - HAROLD WAY LIVE/WORK UNIT ENTRIES  
A3-202 NOT TO SCALE



2 PERSPECTIVE - NORTH WEST CORNER AERIAL  
A3-202 NOT TO SCALE



3 PERSPECTIVE - ALLSTON WAY AND HAROLD WAY RETAIL ENTRY  
A3-202 NOT TO SCALE



4 PERSPECTIVE - ALLSTON WAY AND HAROLD WAY CORNER  
A3-202 NOT TO SCALE

PROJECT #: 121246  
DRAWN BY: TF, RK  
CHECKED BY: MM

**NILES BOLTON ASSOCIATES**

3060 Peachtree Rd. N.W.  
Suite 600  
Atlanta, GA 30305  
T 404 365 7600  
www.nilesbolton.com

APPLICANT:  
BILL SCHRADER  
T 925 638 8782

No.	Description	Date
8	USE PERMIT RESUBMIT.	3/17/22
9	SAP RESUBMIT.	3/23/22
11	USE PERMIT RESUBMIT.	3/28/22
12	APRIL DRC MEETING	4/11/22
13	JUNE LWRKS. MEETING	5/10/22

This drawing, as an instrument of service, is and shall remain the property of the Architect and shall not be reproduced, published or used in any way without the permission of the Architect.

**BERKELEY PLAZA**  
2065 KITTREDGE ST  
BERKELEY, CA 94704

CA VENTURES

SHEET TITLE:  
**PERSPECTIVES**

SHEET NUMBER:  
**A3-202**

# JUNE 21 MORNING

2 HOURS AFTER SUNRISE - 7:47 AM

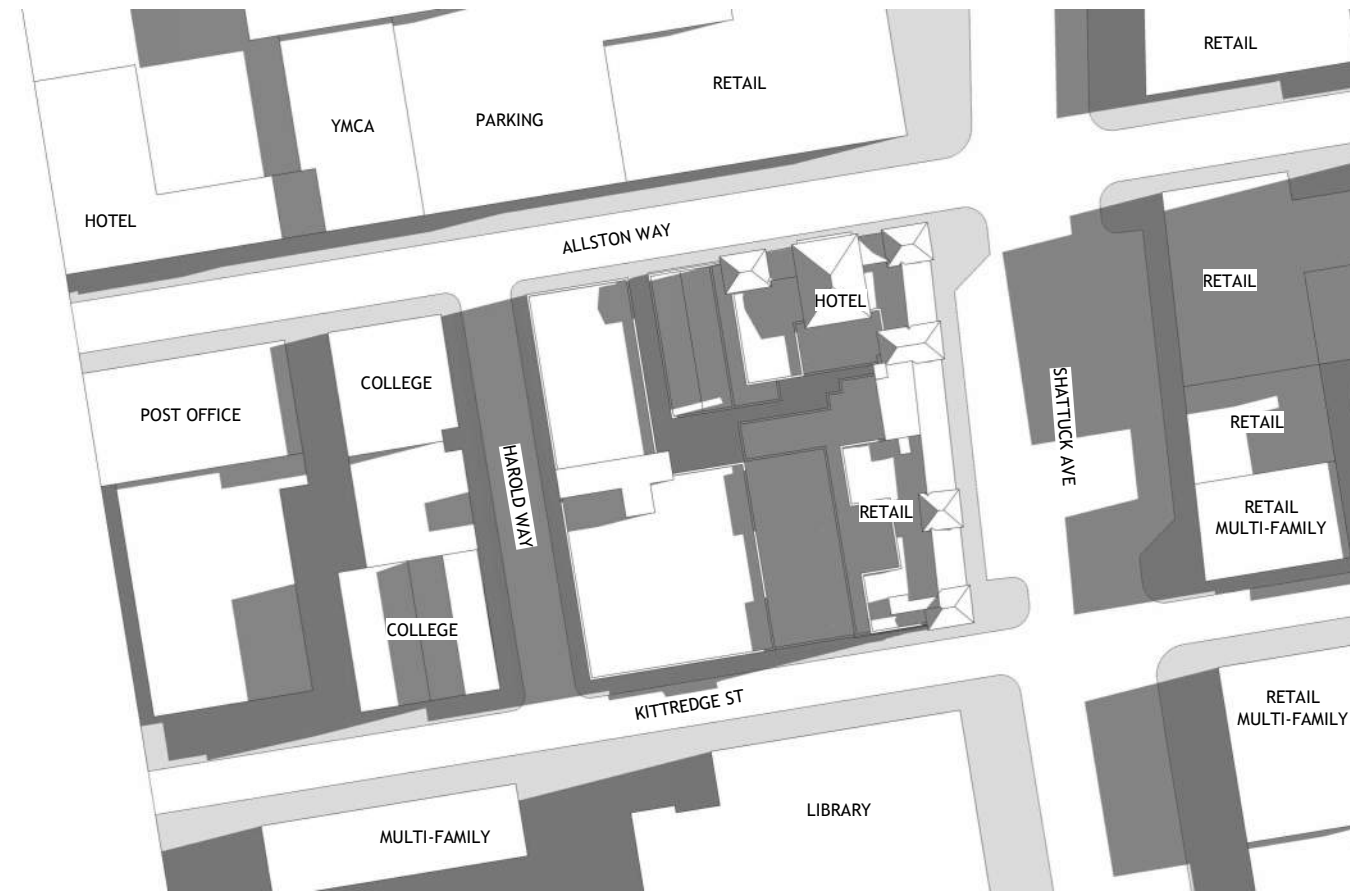

TOP VIEW EXISTING



TOP VIEW PROPOSED

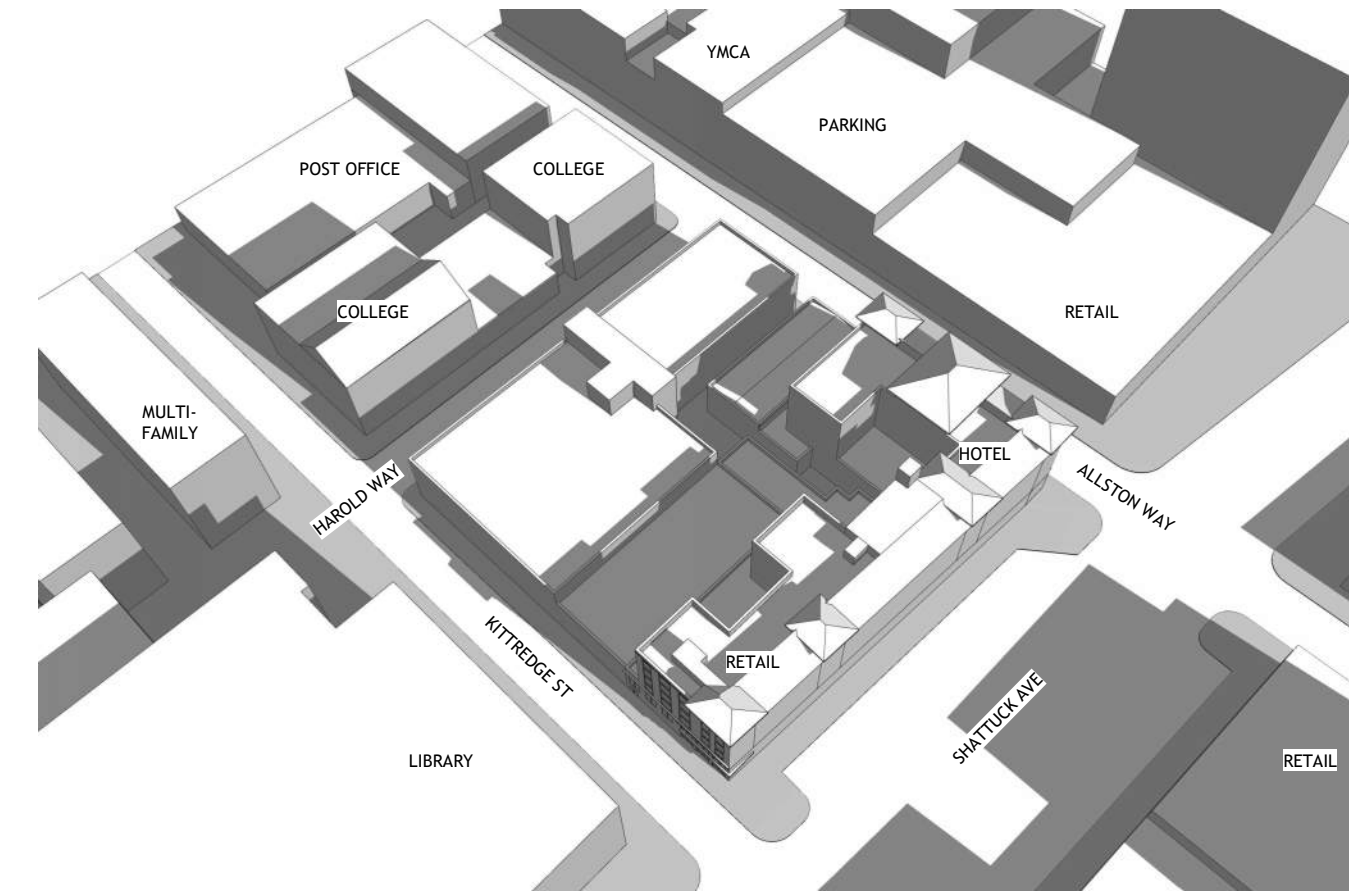

ANGLE VIEW EXISTING

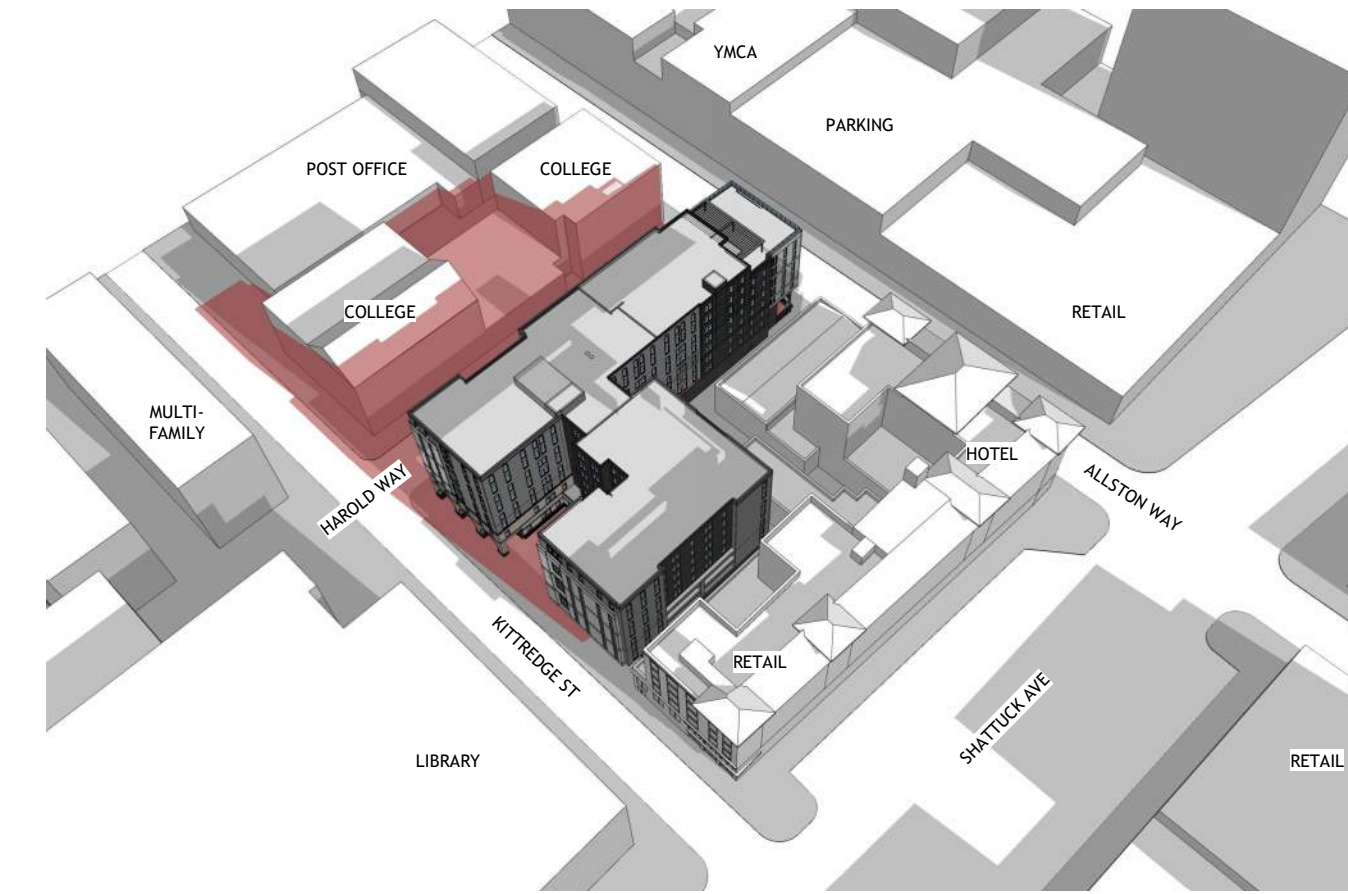

ANGLE VIEW PROPOSED

NEW SHADOWS FROM PROPOSED PROJECT SHOWN IN RED

# JUNE 21 NOON

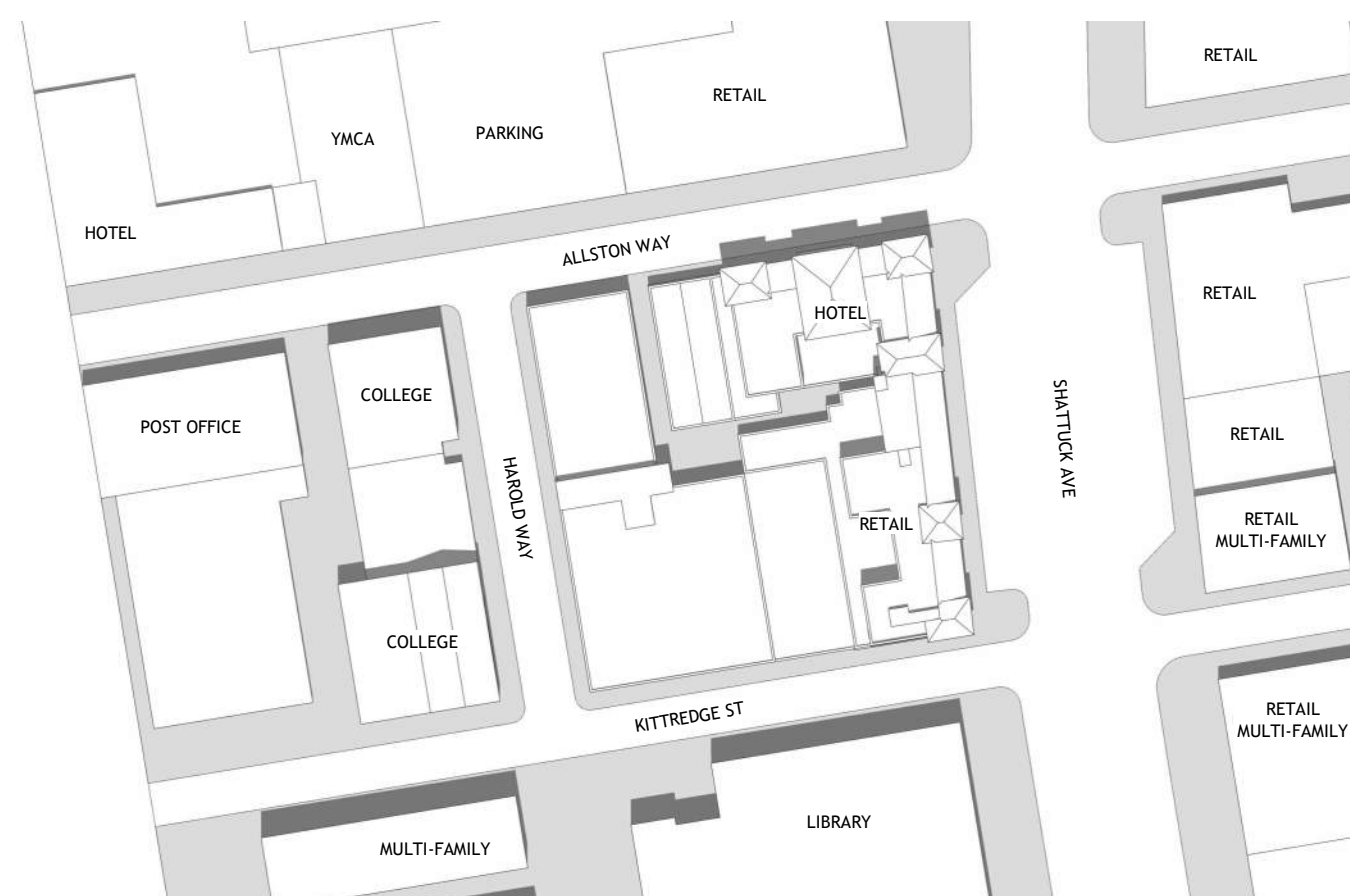

TOP VIEW EXISTING

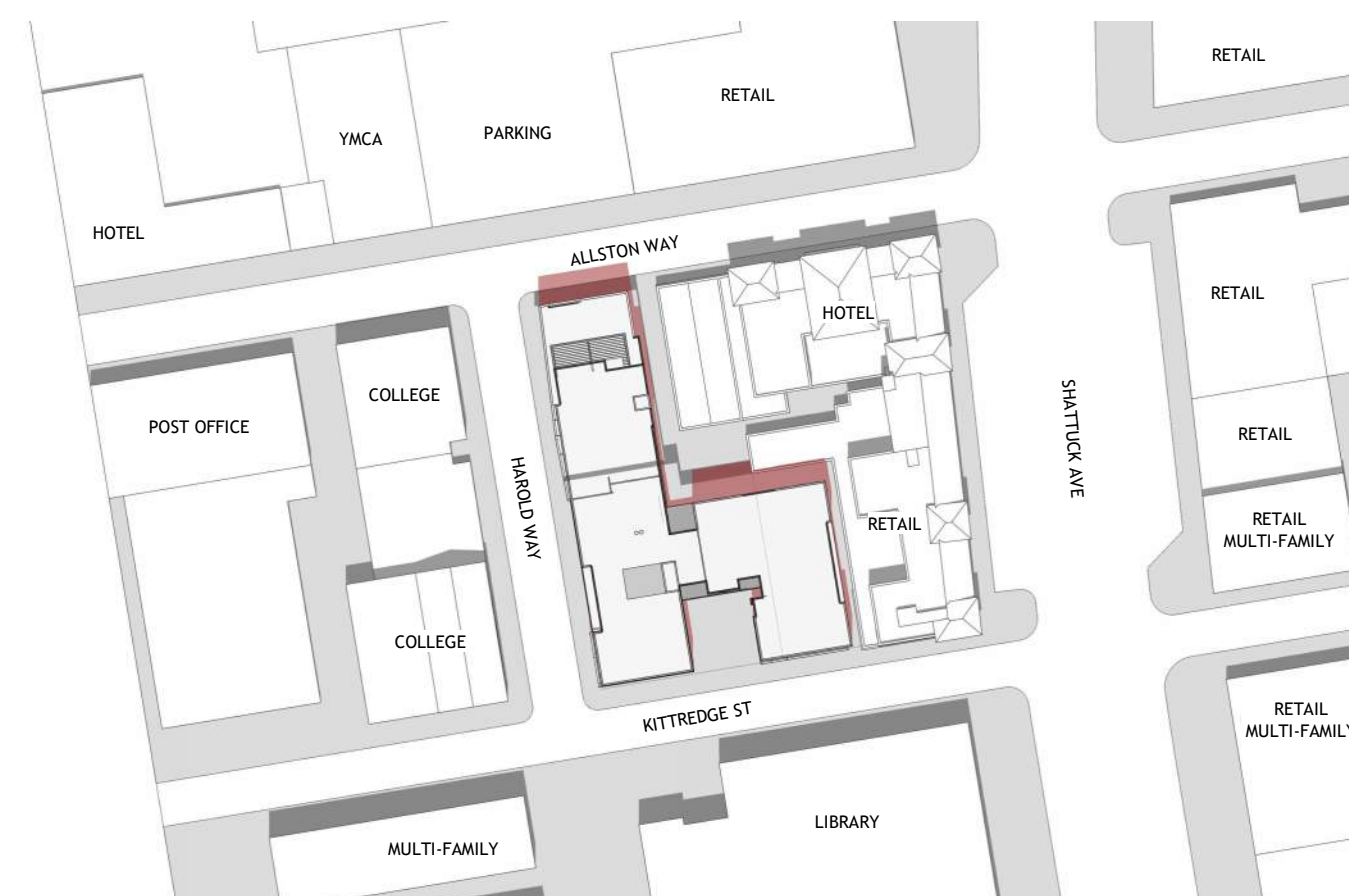

TOP VIEW PROPOSED

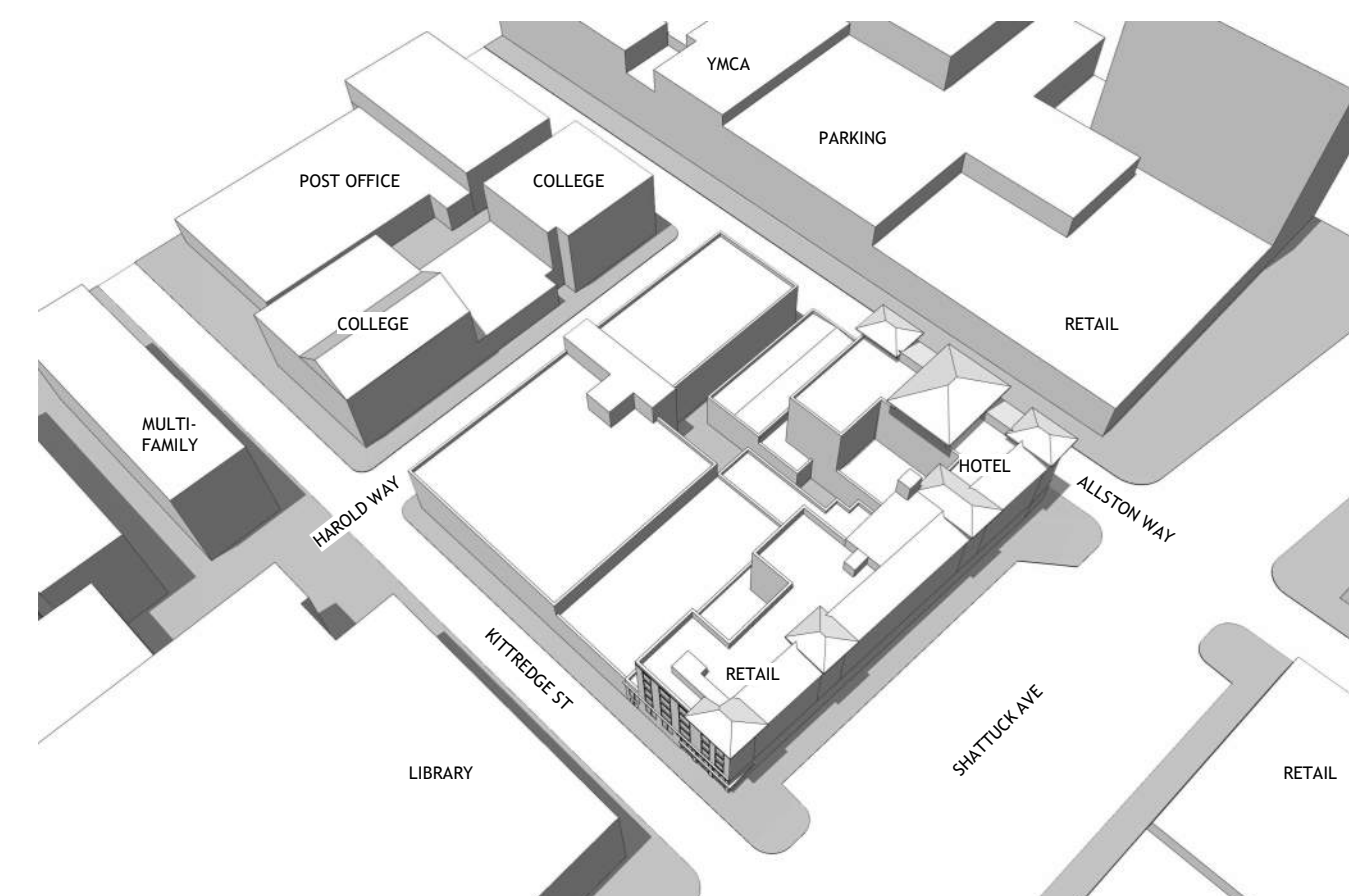

ANGLE VIEW EXISTING

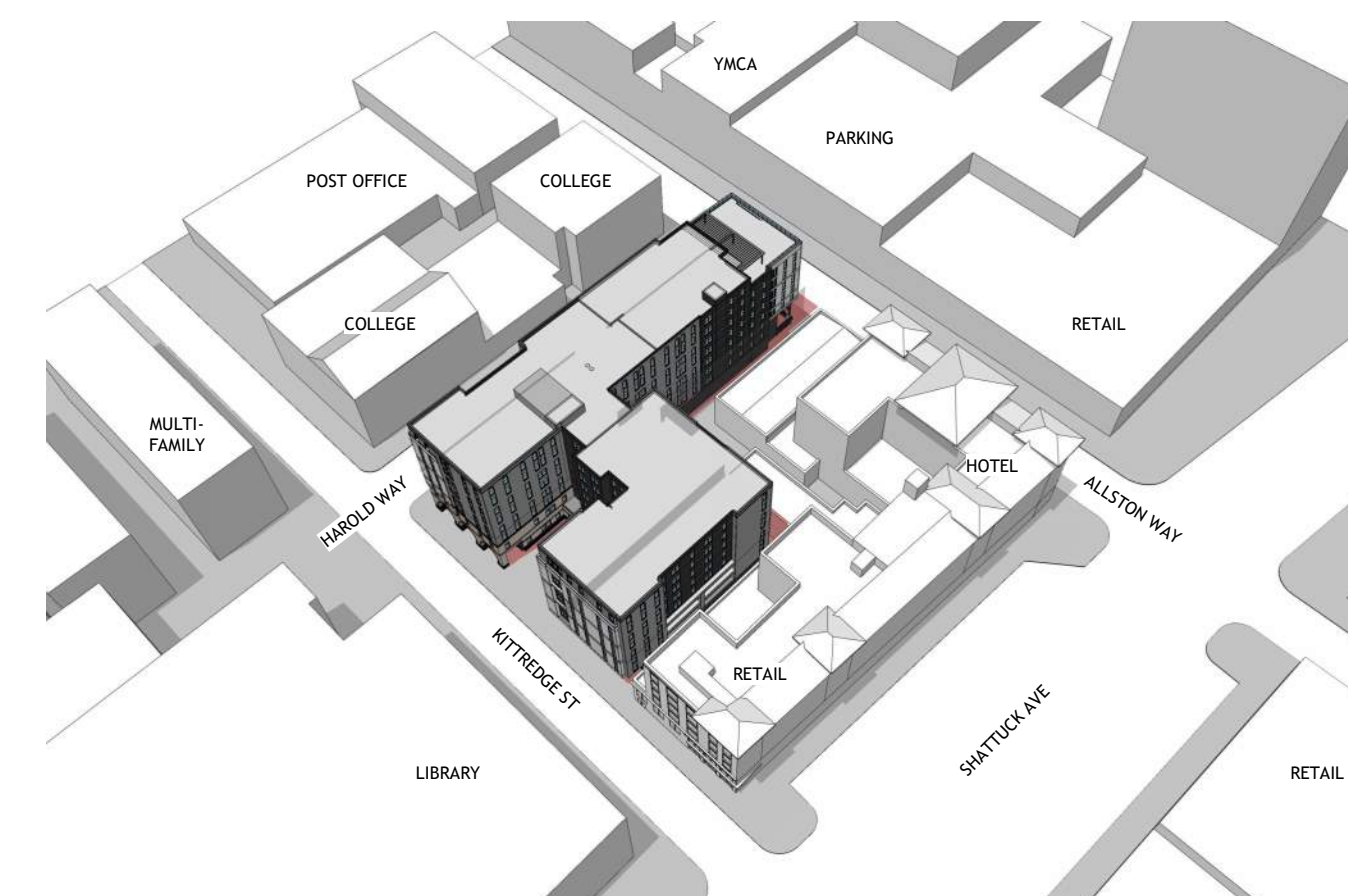

ANGLE VIEW PROPOSED

# JUNE 21 EVENING

2 HOURS BEFORE SUNSET - 6:34 PM

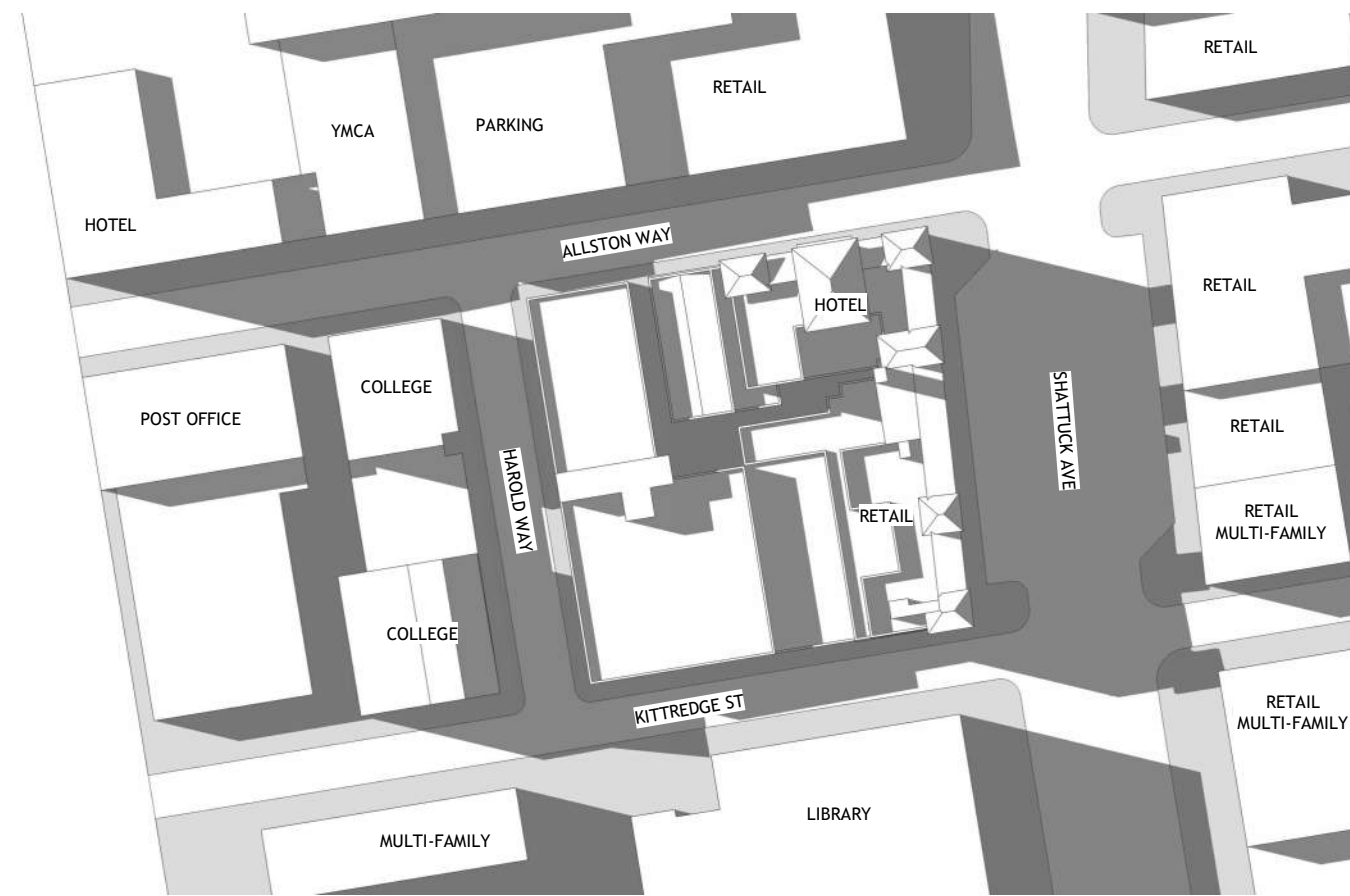

TOP VIEW EXISTING



TOP VIEW PROPOSED

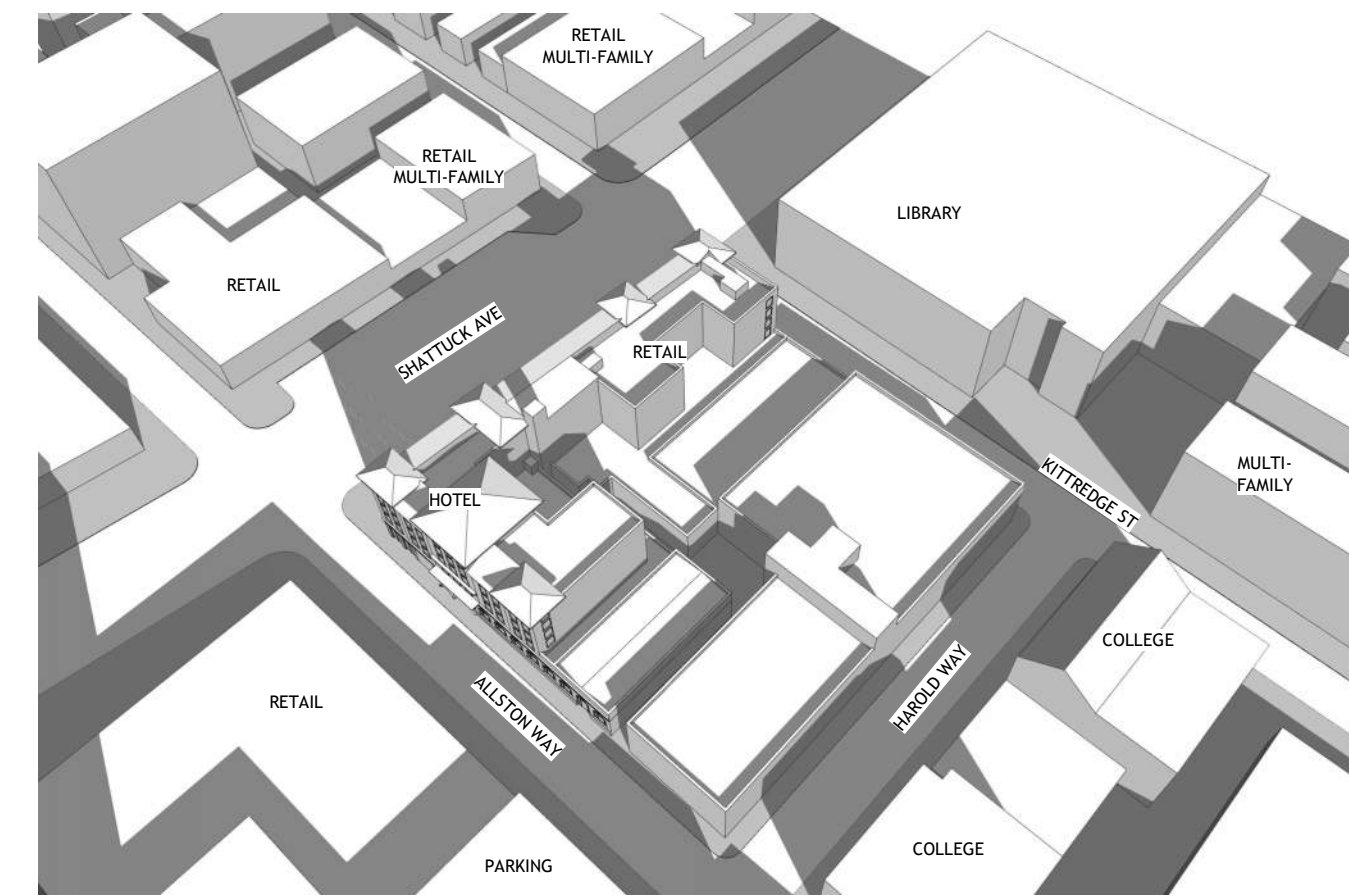

ANGLE VIEW EXISTING

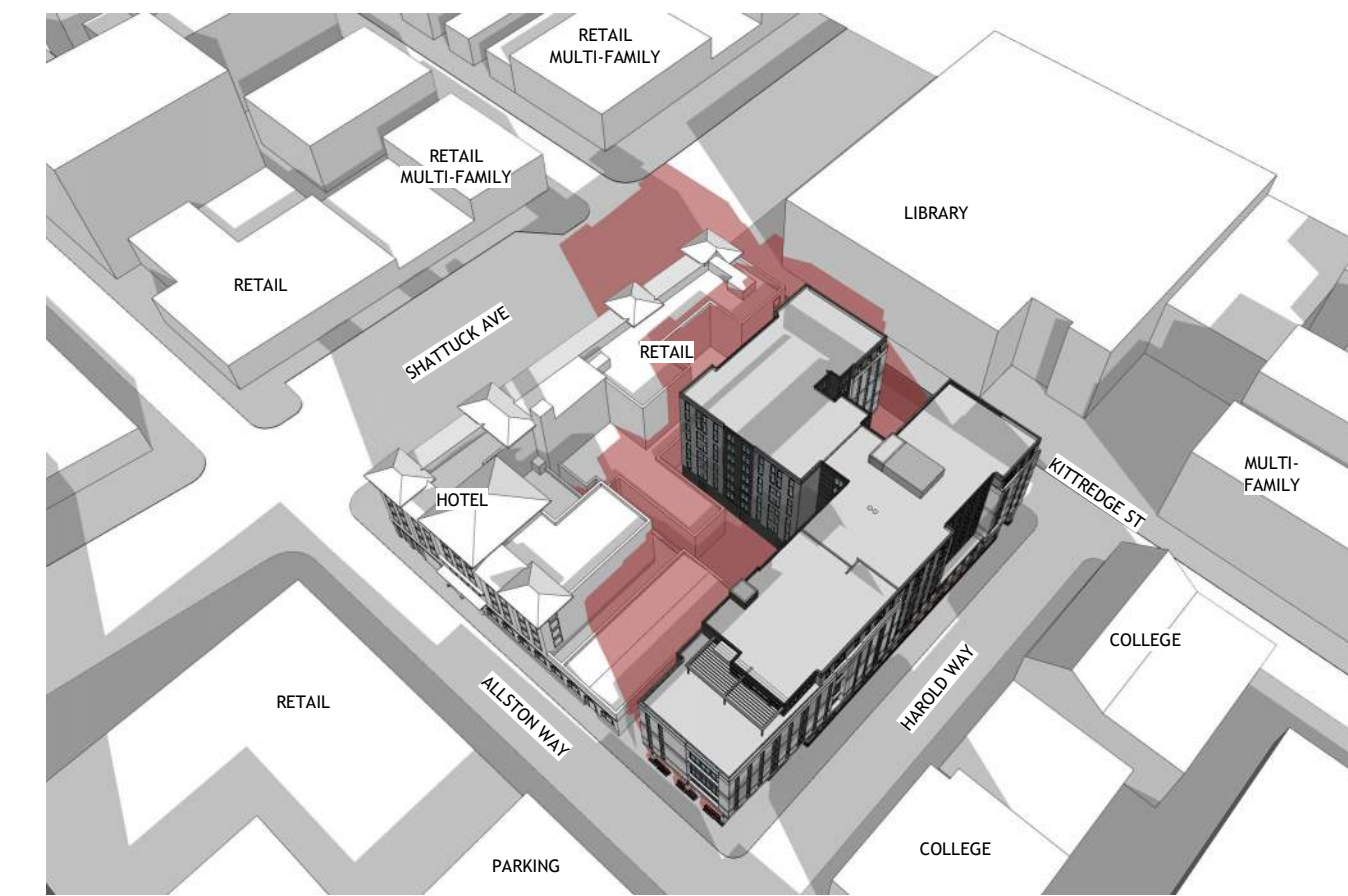

ANGLE VIEW PROPOSED

PROJECT #: 121246  
DRAWN BY: TF  
CHECKED BY: MM

**NILES BOLTON ASSOCIATES**

3060 Peachtree Rd. N.W.  
Suite 600  
Atlanta, GA 30305  
T 404 365 7600  
www.nilesbolton.com

APPLICANT:  
BILL SCHRADER  
T 925 638 8782

No.	Description	Date
4	USE PERMIT	10/25/21
5	USE PERMIT RESUBMIT.	12/10/21
6	SAP	12/22/21
9	SAP RESUBMIT.	3/23/22
12	APRIL DRG MEETING	4/11/22
13	JUNE LWRKS. MEETING	5/10/22

This drawing, as an instrument of service, is and shall remain the property of the Architect and shall not be reproduced, published or used in any way without the permission of the Architect.

**BERKELEY PLAZA**  
2065 KITTRIDGE ST  
BERKELEY, CA 94704

CA VENTURES

SHEET TITLE:  
SHADOW STUDIES -  
JUNE 21

SHEET NUMBER:  
**A3-301**

NOT RELEASED FOR CONSTRUCTION

# DECEMBER 21 MORNING

2 HOURS AFTER SUNRISE - 9:21 AM

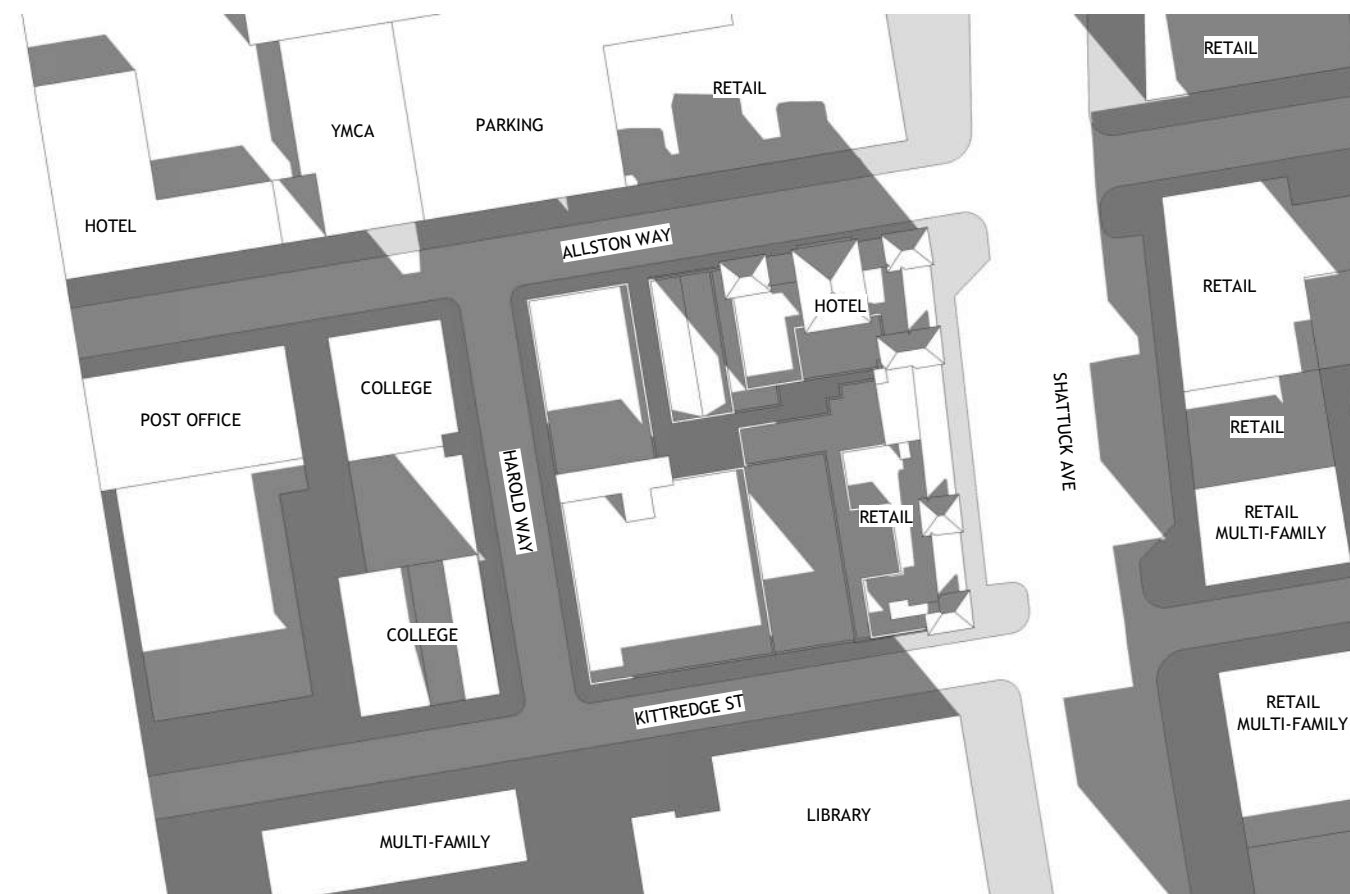

TOP VIEW EXISTING



TOP VIEW PROPOSED

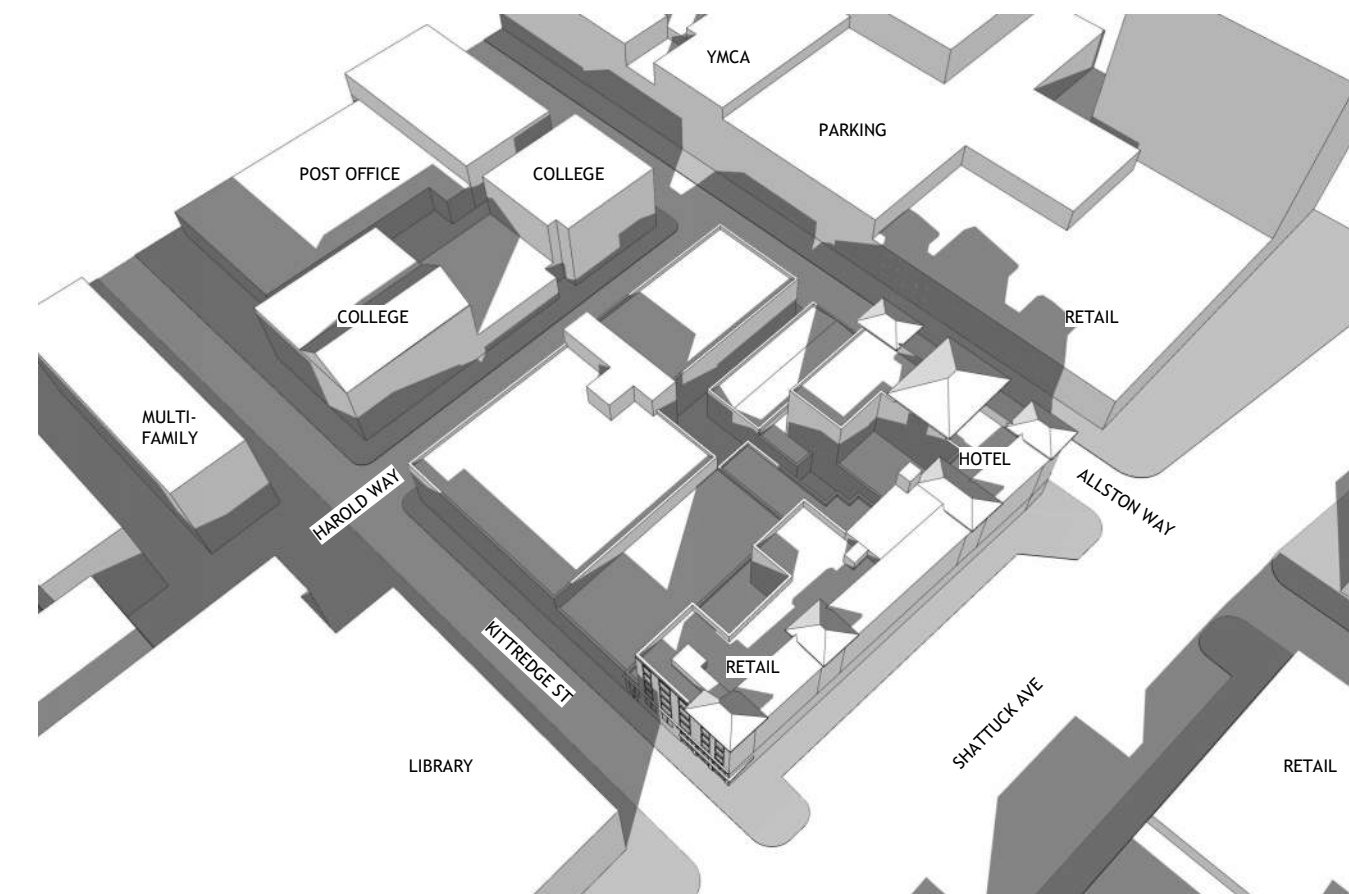

ANGLE VIEW EXISTING

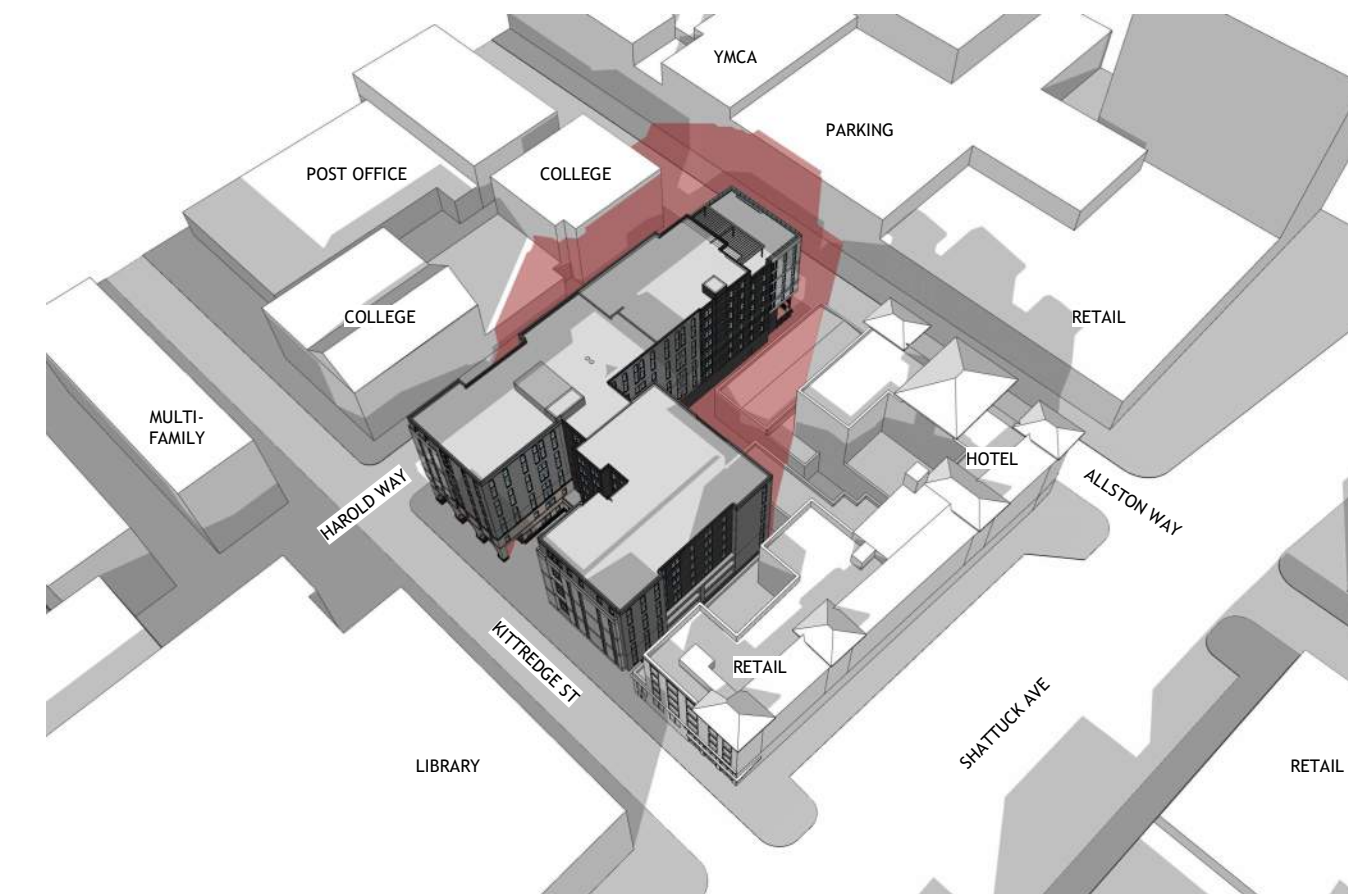

ANGLE VIEW PROPOSED

NEW SHADOWS FROM PROPOSED PROJECT SHOWN IN RED

# DECEMBER 21 NOON



TOP VIEW EXISTING



TOP VIEW PROPOSED

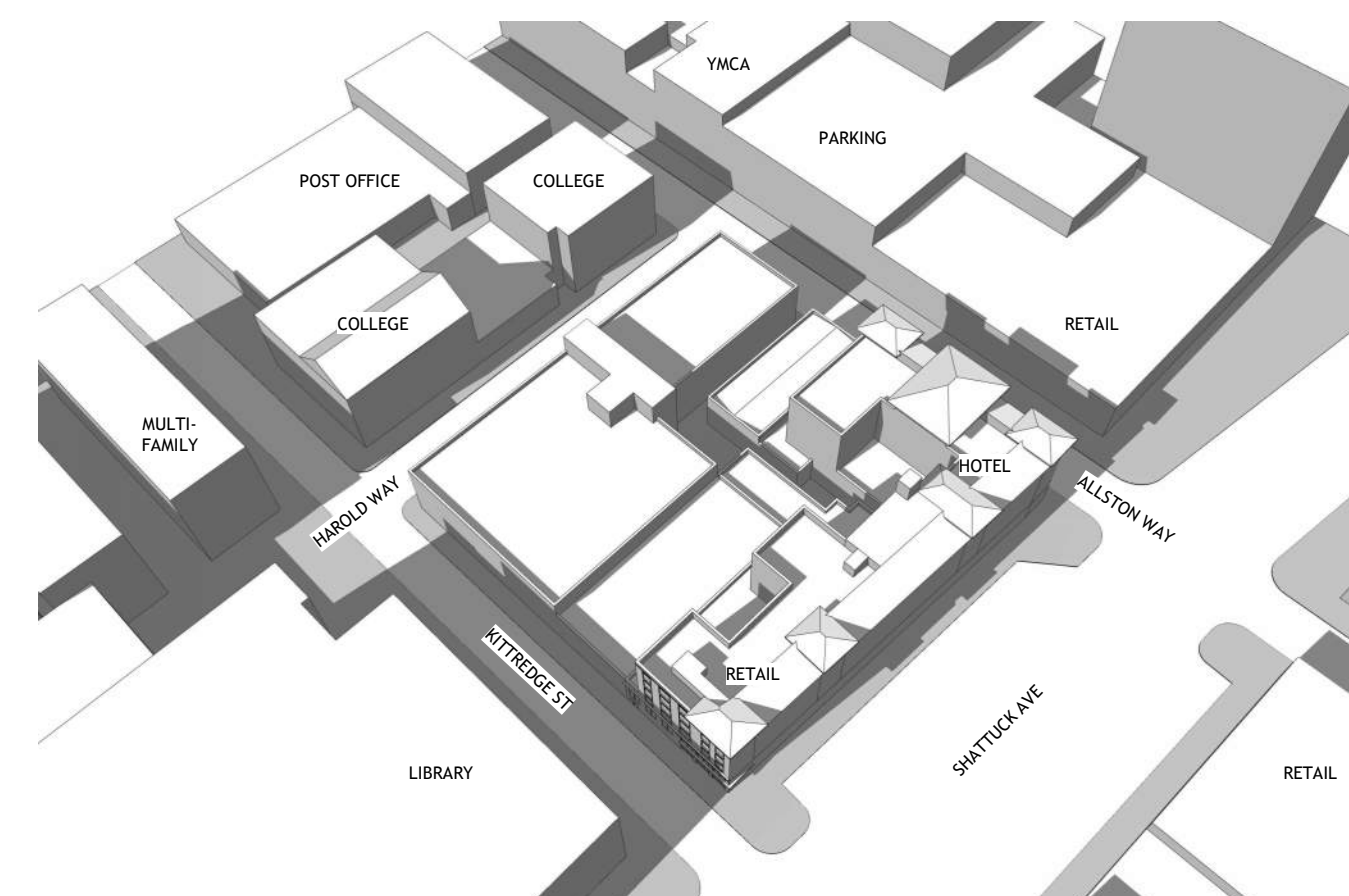

ANGLE VIEW EXISTING

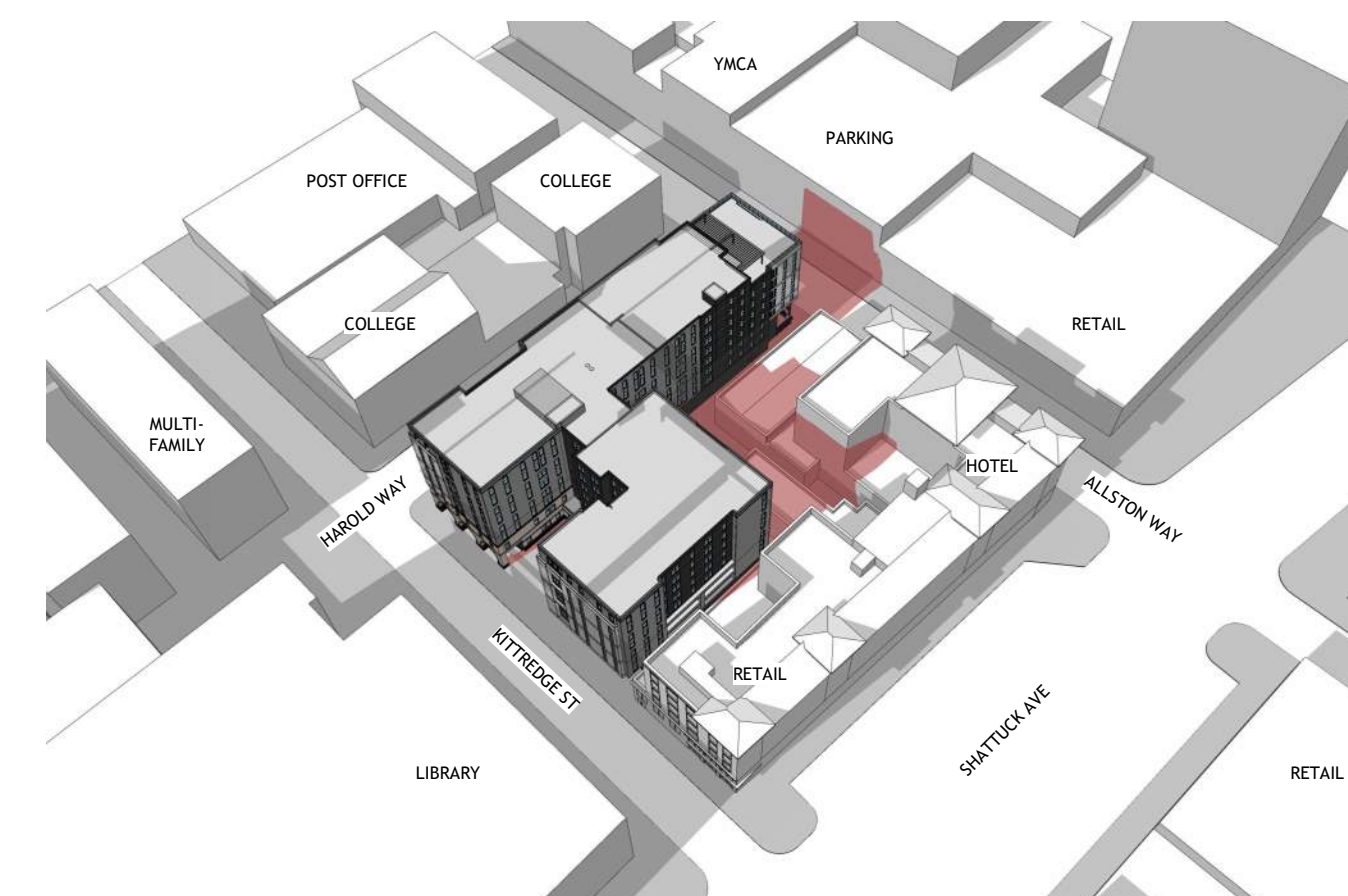

ANGLE VIEW PROPOSED

# DECEMBER 21 EVENING

2 HOURS BEFORE SUNSET - 2:53 PM



TOP VIEW EXISTING



TOP VIEW PROPOSED

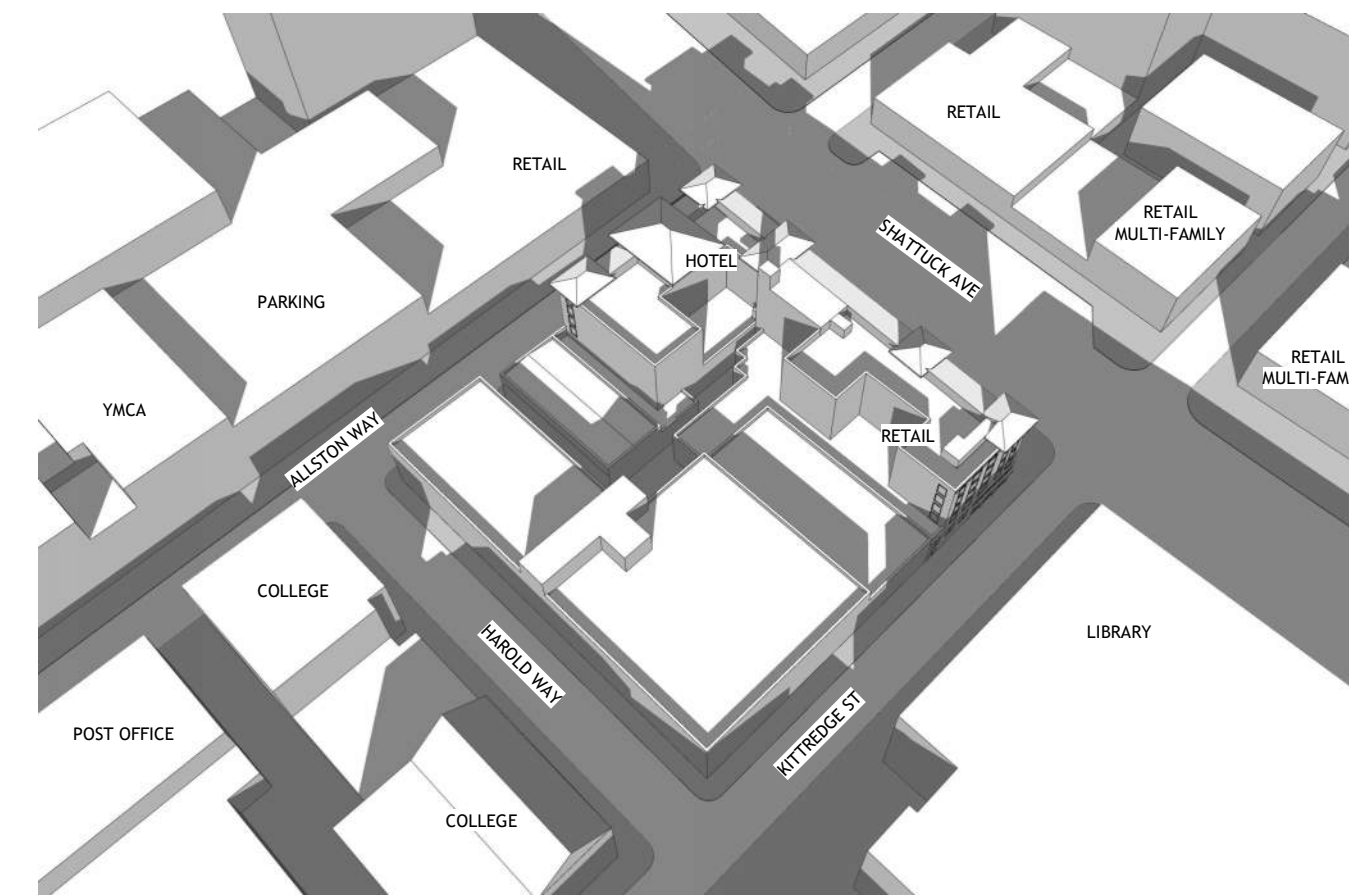

ANGLE VIEW EXISTING

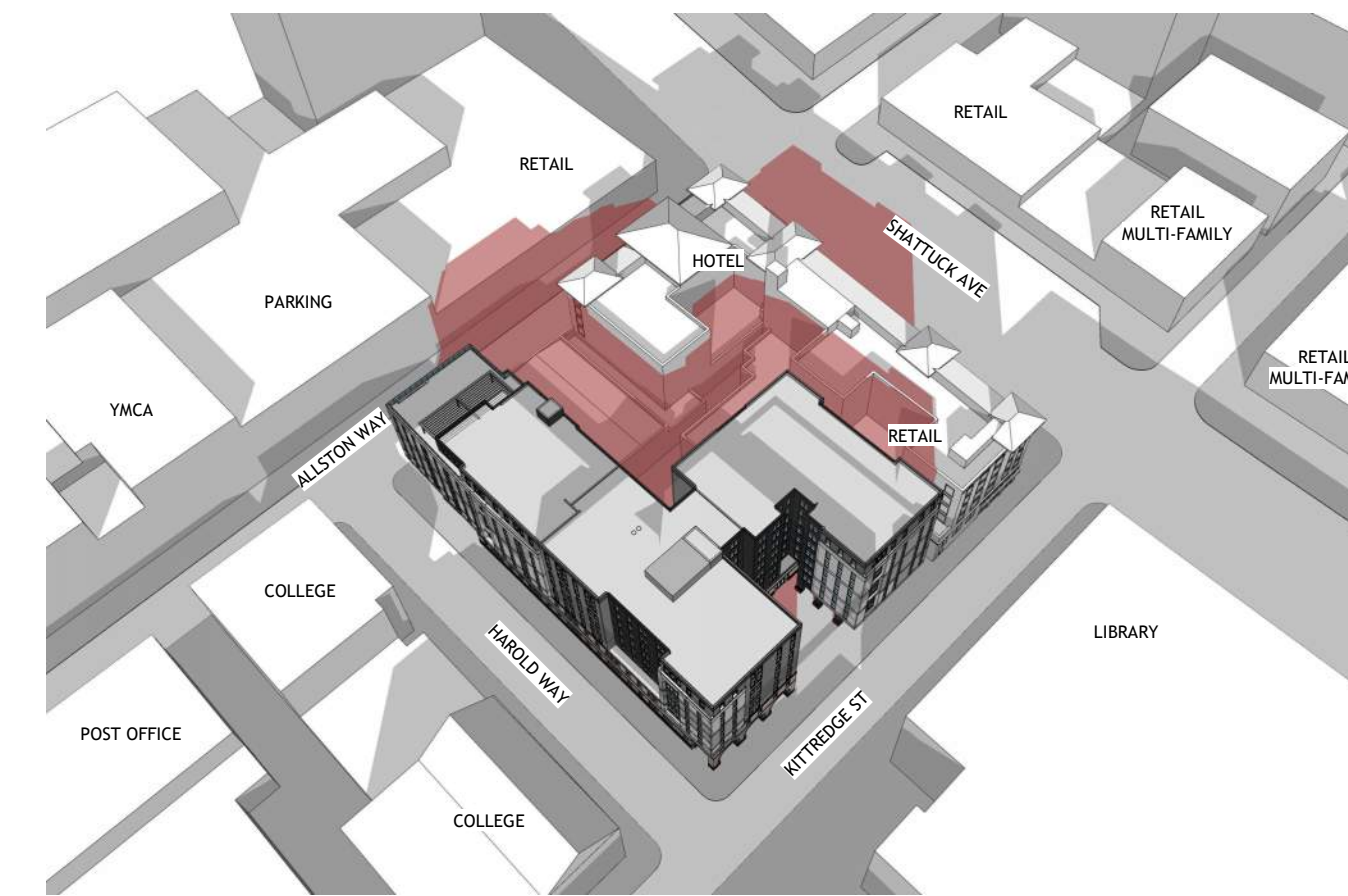

ANGLE VIEW PROPOSED

PROJECT #: 121246  
DRAWN BY: TF  
CHECKED BY: MM

**NILES BOLTON ASSOCIATES**

3060 Peachtree Rd. N.W.  
Suite 600  
Atlanta, GA 30305  
T 404 365 7600  
www.nilesbolton.com

APPLICANT:  
BILL SCHRADER  
T 925 638 8782

No.	Description	Date
5	USE PERMIT RESUBMIT.	12/10/21
6	SAP	12/22/21
9	SAP RESUBMIT.	3/23/22
12	APRIL DRC MEETING	4/11/22
13	JUNE LWRKS. MEETING	5/10/22

This drawing, as an instrument of service, is and shall remain the property of the Architect and shall not be reproduced, published or used in any way without the permission of the Architect.

**BERKELEY PLAZA**  
2065 KITTREDGE ST  
BERKELEY, CA 94704

CA VENTURES

SHEET TITLE:  
SHADOW STUDIES  
-DEC 21

SHEET NUMBER:  
**A3-302**

NOT RELEASED FOR CONSTRUCTION

# DECEMBER 10 MORNING

2 HOURS AFTER SUNRISE - 9:14 AM

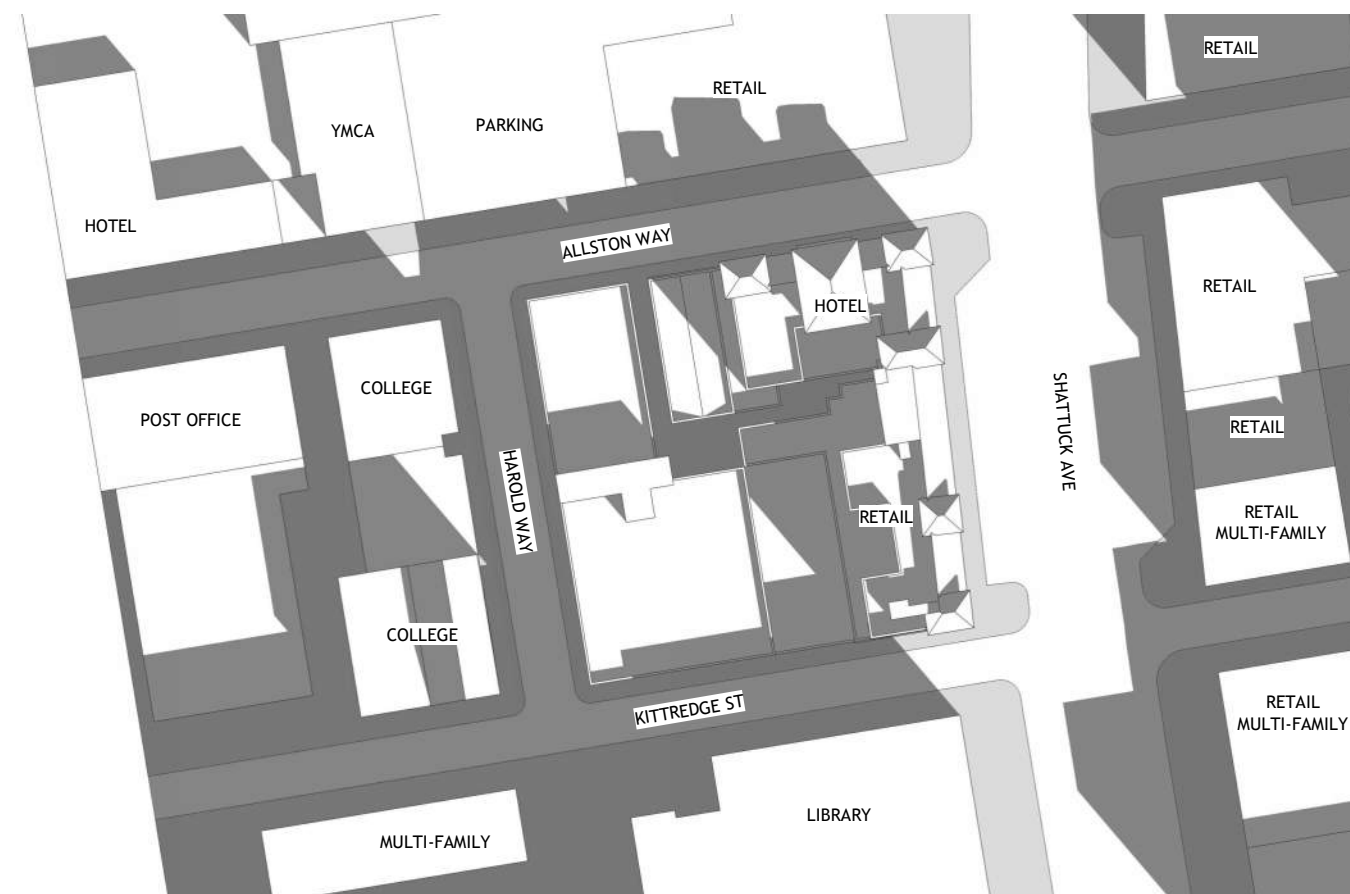

TOP VIEW EXISTING



TOP VIEW PROPOSED

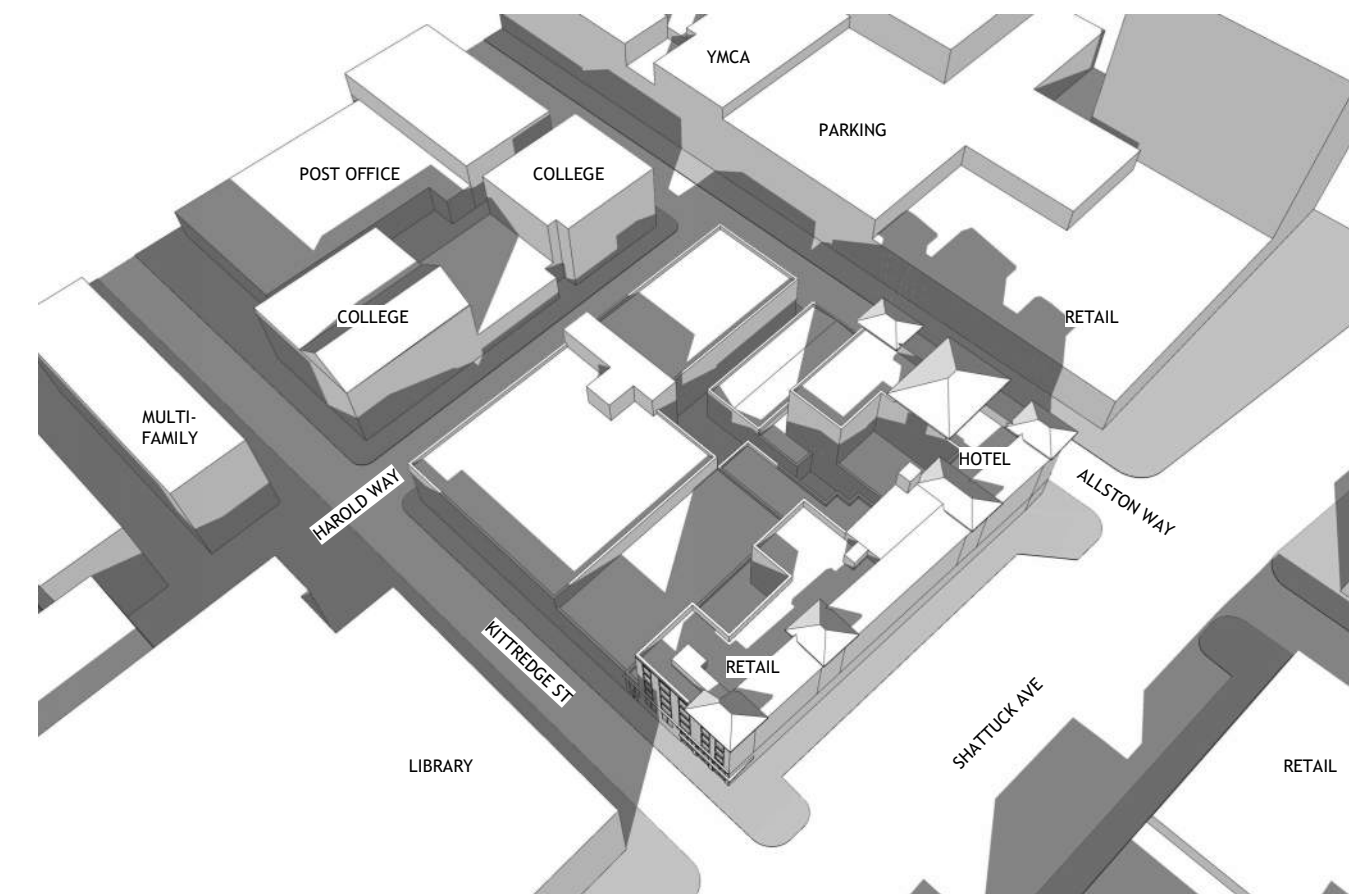

ANGLE VIEW EXISTING

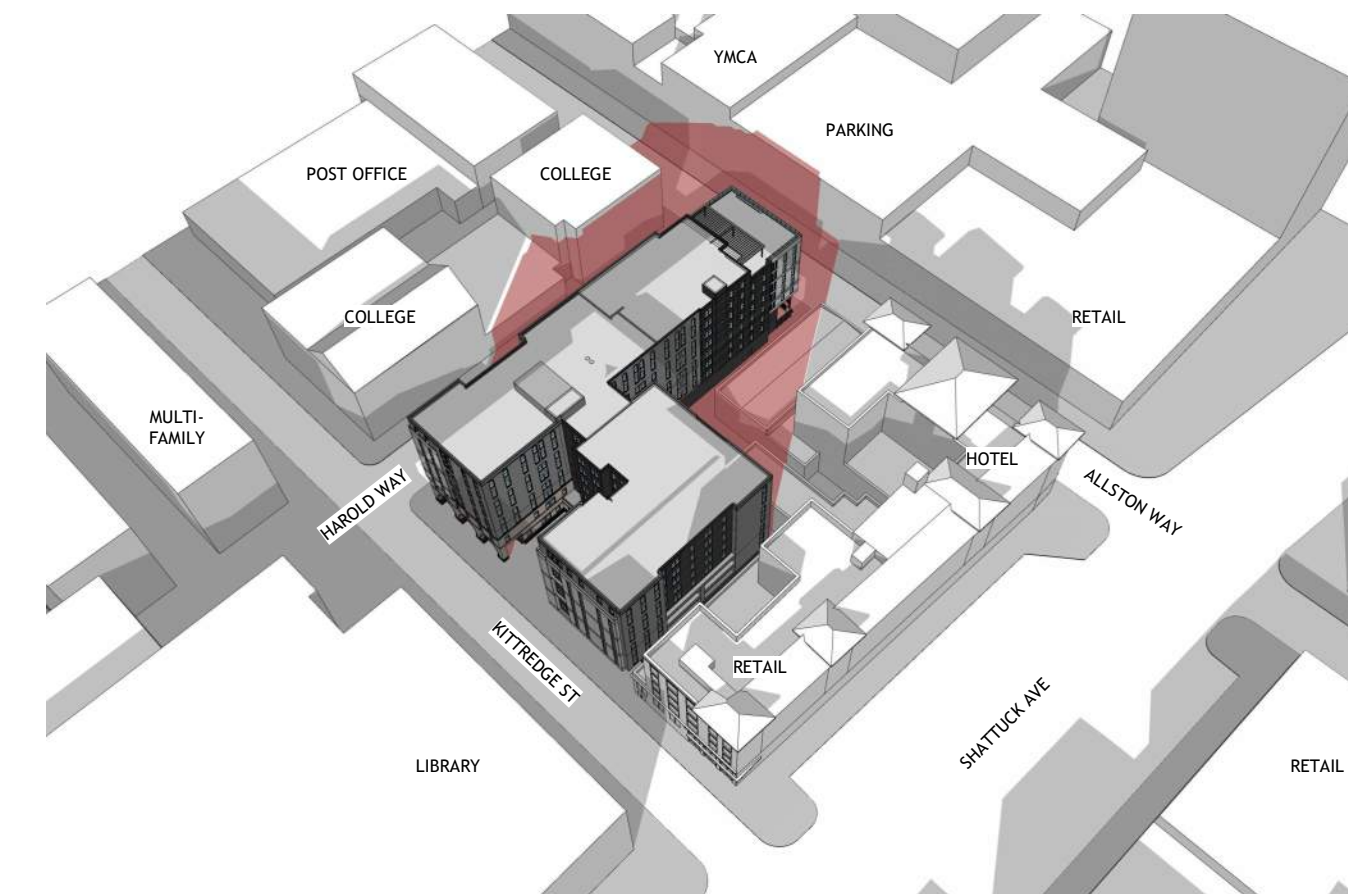

ANGLE VIEW PROPOSED

NEW SHADOWS FROM PROPOSED PROJECT SHOWN IN RED

# DECEMBER 10 NOON



TOP VIEW EXISTING



TOP VIEW PROPOSED

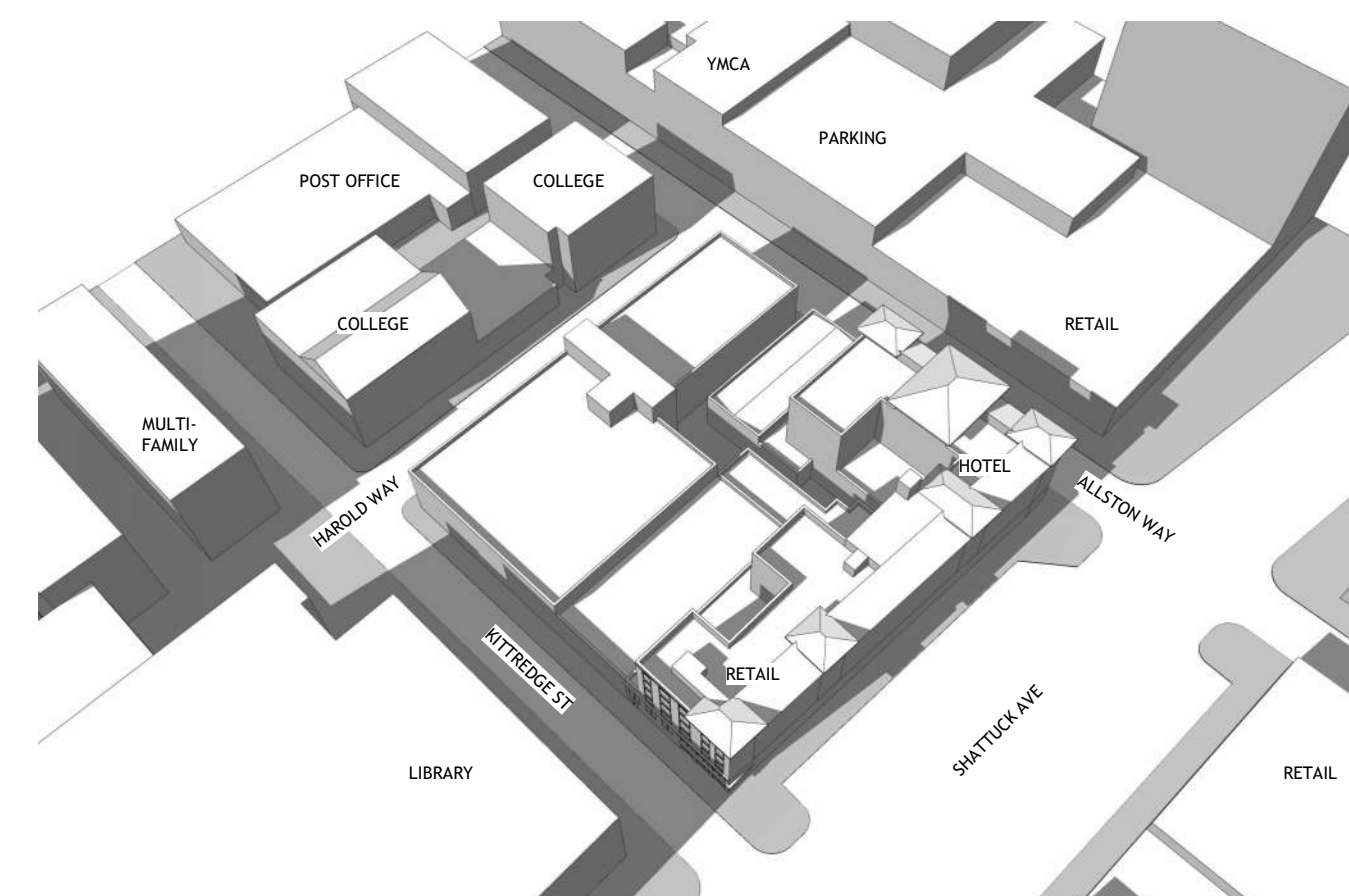

ANGLE VIEW EXISTING

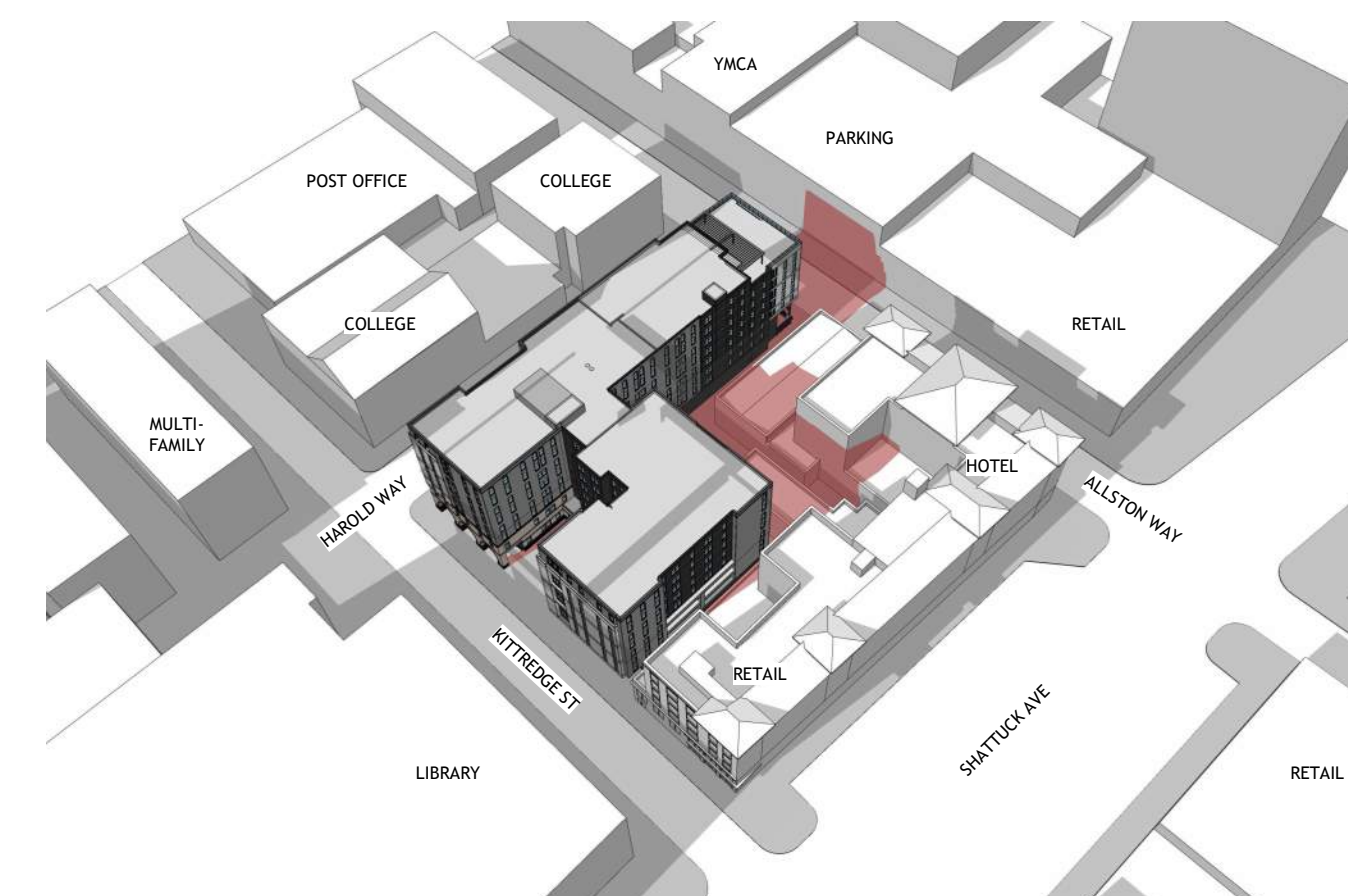

ANGLE VIEW PROPOSED

# DECEMBER 10 EVENING

2 HOURS BEFORE SUNSET - 2:49 PM



TOP VIEW EXISTING



TOP VIEW PROPOSED

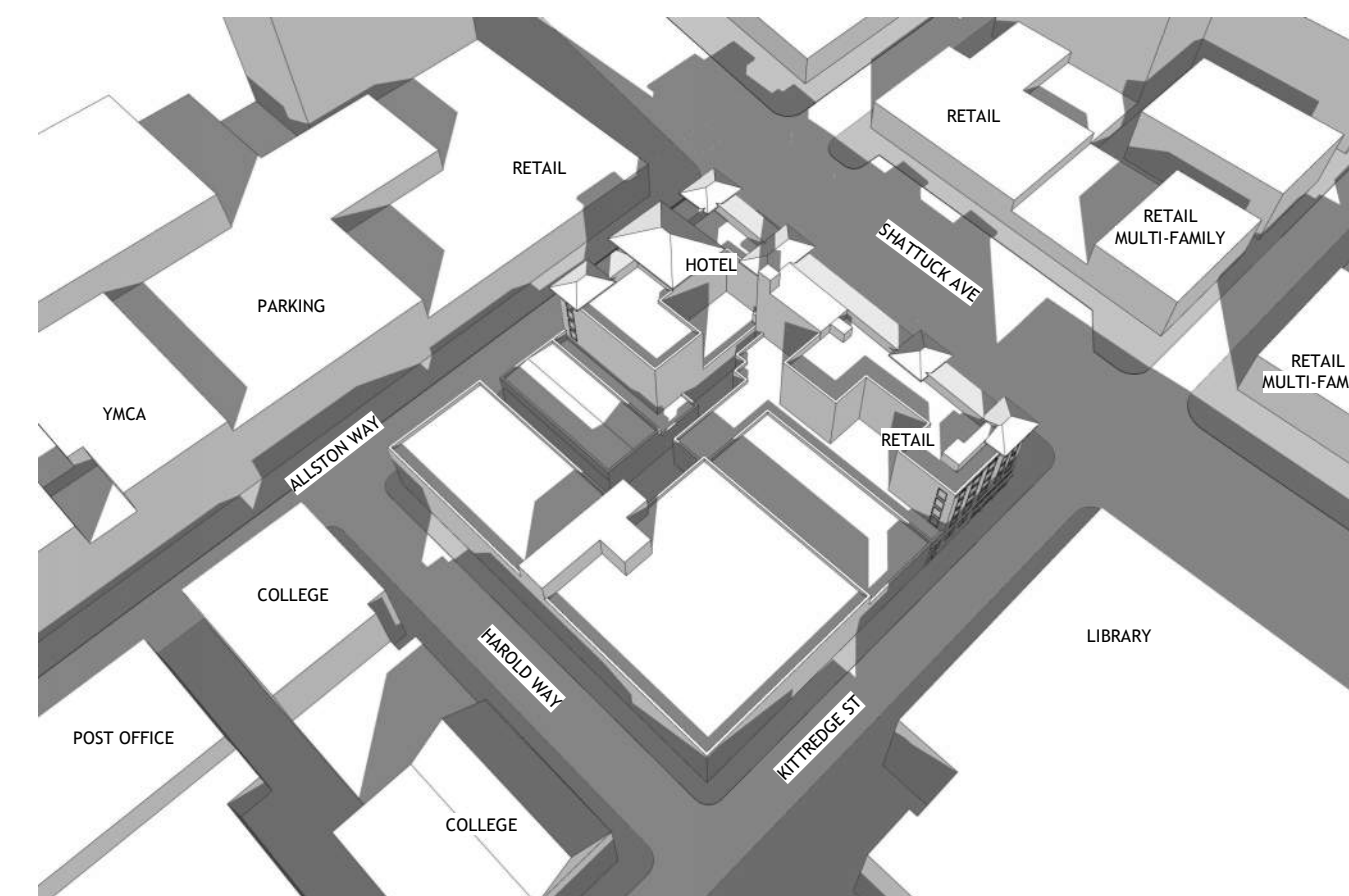

ANGLE VIEW EXISTING

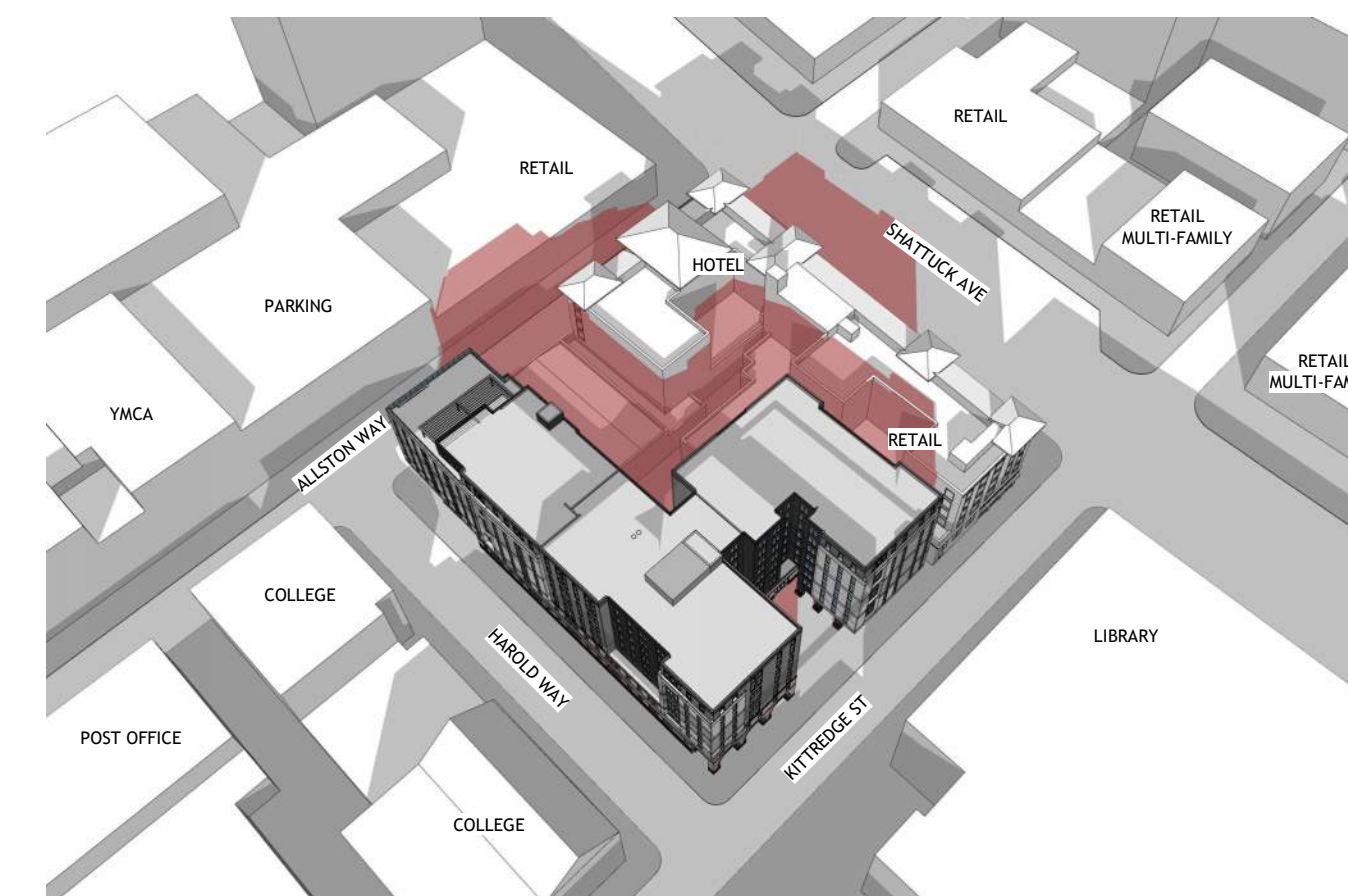

ANGLE VIEW PROPOSED

PROJECT #: 121246  
DRAWN BY: TF  
CHECKED BY: MM

**NILES BOLTON ASSOCIATES**

3060 Peachtree Rd. N.W.  
Suite 600  
Atlanta, GA 30305  
T 404 365 7600  
www.nilesbolton.com

APPLICANT:  
BILL SCHRADER  
T 925 638 8782

No.	Description	Date
5	USE PERMIT RESUBMIT.	12/10/21
6	SAP	12/22/21
9	SAP RESUBMIT.	3/23/22
12	APRIL DRC MEETING	4/11/22
13	JUNE LWRKS. MEETING	5/10/22

This drawing, as an instrument of service, is and shall remain the property of the Architect and shall not be reproduced, published or used in any way without the permission of the Architect.

**BERKELEY PLAZA**  
2065 KITTREDGE ST  
BERKELEY, CA 94704

CA VENTURES

SHEET TITLE:  
SHADOW STUDIES  
-DEC 10

SHEET NUMBER:  
**A3-303**

NOT RELEASED FOR CONSTRUCTION